



## Standard capsule pressure gauges for differential pressure type D9



### Benefits

- Measurement of extremely small differential pressures
- Robust design
- Static pressures up to 400 mbar
- Direct indication of the differential pressure
- Many customised versions available

### Application

For differential pressure measurement of non-corrosive, gaseous, dry media. Especially suitable for filter loss measurement in air conditioning and ventilation applications.

! For measuring gas or vapour, observe the table "Selection Criteria as per EN 837-2" (see appendix)!

### Technical specifications

#### Type

D9

#### Nominal size

63

#### Accuracy class (EN 837-3/6)

4,0

1,6

#### Ranges (EN 837-3/5)

See ordering table

#### Application area

Static load: Full scale value

Dynamic load: 0.9 x full scale value

#### Overpressure safety

Full scale value

400 mbar

#### Operating temperature range

Medium: Max. 60 °C

Ambient: -20/+60 °C

#### Temperature performance

Indication error when the temperature of the measuring system deviates from the normal temperature of 20 °C:  
of full scale value

#### Degree of protection

IP 66 (EN 60529)

### Standard version

#### Connection

Brass, centre back, parallel, below each other

#### Zero correction

From the front

#### Bayonet type bezel

Stainless steel 304



## Options

- Back flange
- 3-hole fixing, panel mounting bezel
- Special scales
- Other process connections

## Technical drawings

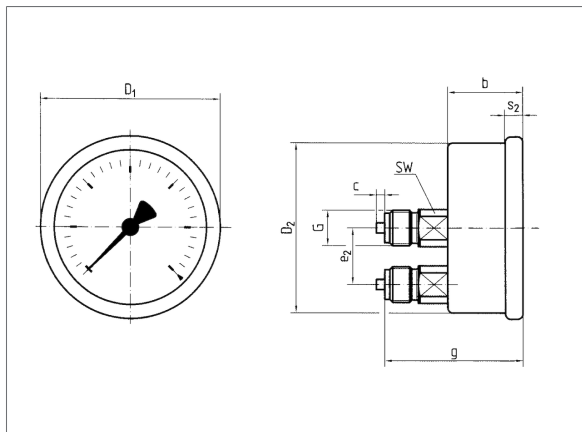

### Dimensions (mm)

NG	b	c	D1	D2	e2	g	G	s2	SW
63	30,5	2	68	62	20	53	G $\frac{1}{4}$ B	6	14

## Versions

### KP63Dif D911

Housing $\varnothing$	Housing	Accuracy class	Connection	Range	Type	Part no.
63 mm	Stainless steel 304	4,0	2 x G $\frac{1}{4}$ B	0/16 mbar	KP63Dif D911	35515911
63 mm	Stainless steel 304	1,6	2 x G $\frac{1}{4}$ B	0/25 mbar	KP63Dif D911	35516911
63 mm	Stainless steel 304	1,6	2 x G $\frac{1}{4}$ B	0/40 mbar	KP63Dif D911	35517911
63 mm	Stainless steel 304	1,6	2 x G $\frac{1}{4}$ B	0/60 mbar	KP63Dif D911	35518911
63 mm	Stainless steel 304	1,6	2 x G $\frac{1}{4}$ B	0/100 mbar	KP63Dif D911	35519911
63 mm	Stainless steel 304	1,6	2 x G $\frac{1}{4}$ B	0/160 mbar	KP63Dif D911	35520911
63 mm	Stainless steel 304	1,6	2 x G $\frac{1}{4}$ B	0/250 mbar	KP63Dif D911	35521911
63 mm	Stainless steel 304	1,6	2 x G $\frac{1}{4}$ B	0/400 mbar	KP63Dif D911	35522911

Blue part no. = in-stock items